



carell[®]

Disposable, rinse-free
shampoo cap

SHAMPOO CAP

Carell Shampoo Caps are impregnated with a
rinse free shampoo formulation to clean and
soften the hair and scalp.

carell[®]

SHAMPOO CAP

In 88 US hospitals 62.2% of bath basins were contaminated with commonly encountered hospital-acquired pathogens¹.



SAFE SOLUTION

Carell Shampoo Caps remove the risk of microorganism transmission associated with wash bowl contamination. This reduces the associated risk of lifting and carrying heavy bowls of water and the risk of spills and potential falls^{1,2,3}.

REDUCES TRANSFERENCE

Improved patient cleanliness reduces the number of microorganisms available to transfer to healthcare workers, visitors and the environment.

QUICK AND EASY TO USE

Wipes replace the need for cumbersome traditional patient cleansing methods which include preparing bowls, washcloths, soap, lotions and water. They require no towel drying which decreases waste, increases staff compliance and saves money.

USE HOT OR COLD

Use at room temperature or place in a Clinell Warmer for a warm Shampoo Cap.

SIMPLE RINSE FREE HAIR CLEANSING SOLUTION

Soft, rinse free shampoo cap designed for cleaning and moisturising the hair in one easy step. Ensures a consistent coverage helping to clean, freshen and promote a healthy, soft scalp and hair.

GENTLE ON SKIN

Skin neutral pH of 5.5. Dermatologically tested formula. Alcohol, lanolin and paraben free.

PRODUCT	UNIT OF ISSUE	CODE
Shampoo Cap	Single Unit	PRSHMC1

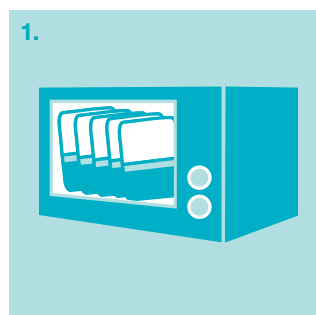

1. Can be used un-warmed or heated. To heat pack, store in a warmer before use or microwave for 15 seconds*.

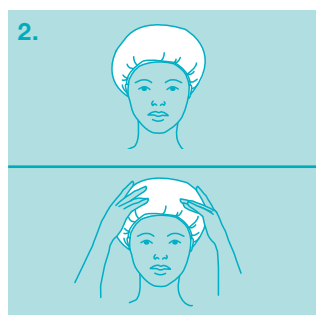

2. Place shampoo cap over hair ensuring it is all covered. Massage your head all over for 2-3 minutes to make sure the hair is completely saturated.

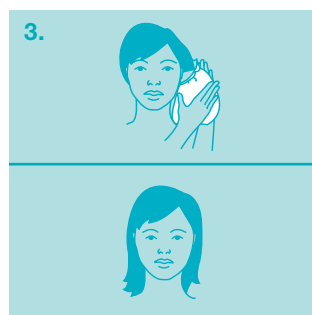

3. To ensure longer hair is properly washed, remove cap and work through the ends of hair. Remove cap and towel dry if required.

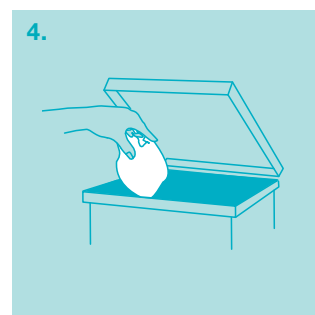

4. Discard of cap in the appropriate waste bin.

* Microwave times may vary depending on power. Test temperature after heating and before use. The Clinell Warmer is suitable for CBB8, CBBGL8, PRSHMC1, CHGW08, CHGWGL8 and CHGCS1.

REFERENCES

1. Johnson, D. Lineweaver, Maze, L. Patients' Bath Basins as Potential Sources of Infection: A Multicenter Sampling Study. American Association of Critical Care nurses. 2012.
2. Ford, S. Clover, B. Antibiotic resistant bacteria risk from hospital sinks. The Department of Health. 2010.
3. Marchaim D et al. Hospital bath basins are frequently contaminated with multidrug-resistant human pathogens. Am J Infect Control. 2012 Aug;40(6):562-4. Epub 2011 Dec 16.

GHA190010